



KI FASTENERS

Mfrs. of :
SS, MS, Brass Fasteners & Precision
All type of Brass Parts

DIN 84 / IS : 1366 - 1982 / ISO 1207

Slotted Cheese Head Screws

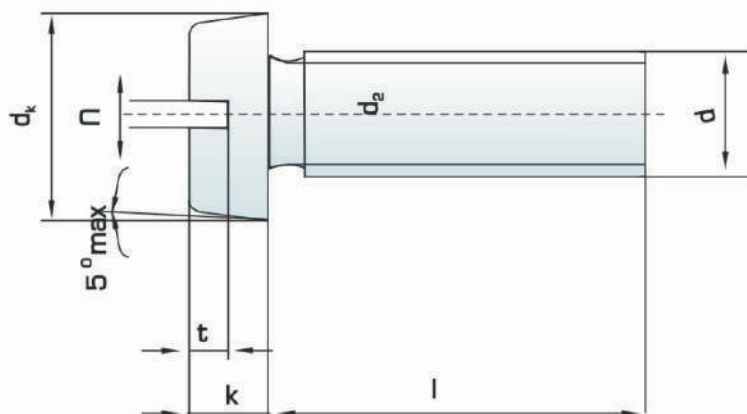

Thread size [d]	M 2	M 2.5	M 3	M 3,5	M 4	M 5	M 6	M 8	M 10
Pitch	0.4	0.45	0.5	0.6	0.7	0.8	1	1.25	1.5
d_k	max.	3.8	4.5	5.5	6	7	8.5	10	16
	min.	3.62	4.32	5.32	5.82	6.78	8.28	9.78	15.73
k	max.	1.3	1.6	2	2.4	2.6	3.3	3.9	6
	min.	1.16	1.46	1.86	2.26	2.46	3.12	3.6	5.7
n	min.	0.5	0.6	0.8	1.0	1.2	1.2	1.6	2.5
	max.	0.7	0.8	1	1.2	1.51	1.51	1.91	2.81
t min.	0.6	0.7	0.85	1	1.1	1.3	1.6	2	2.4

* All Dimensions in mm

DIN 85 / IS : 6101 - 1982 / ISO 1580

Slotted Pan Head Screws

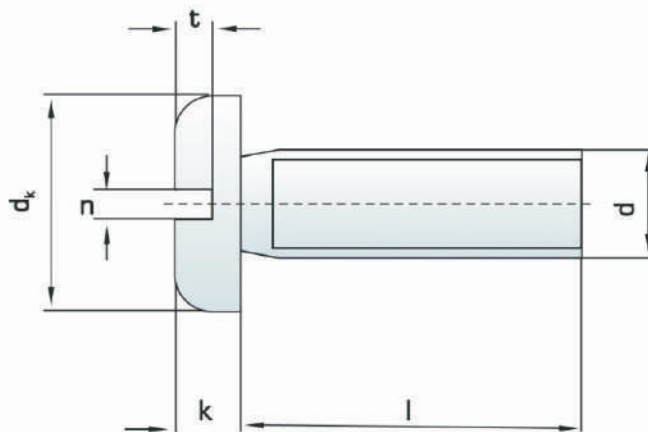

Thread size [d]	M 2	M 2.5	M 3	(M 3.5)	M 4	M 5	M 6	M 8	M 10
Pitch	0.4	0.45	0.5	0.6	0.7	0.8	1	1.25	1.5
d_k	max.	4	5	6	7	8	10	12	20
	min.	3.7	4.7	5.7	6.64	7.64	9.64	11.57	19.48
k	max.	1.3	1.5	1.8	2.1	2.4	3	3.6	6
	min.	1.16	1.36	1.66	1.96	2.26	2.86	3.3	5.7
n	min.	0.5	0.8	0.8	1.0	1.2	1.2	1.6	2.5
	max.	0.7	1	1	1.2	1.51	1.51	1.91	2.81
t min.	0.5	0.6	0.7	0.8	1	1.2	1.4	1.9	2.4

* All Dimensions in mm

DIN 95 / IS : 6736 - 1972

Slotted Raised Countersunk Head Wood Screws

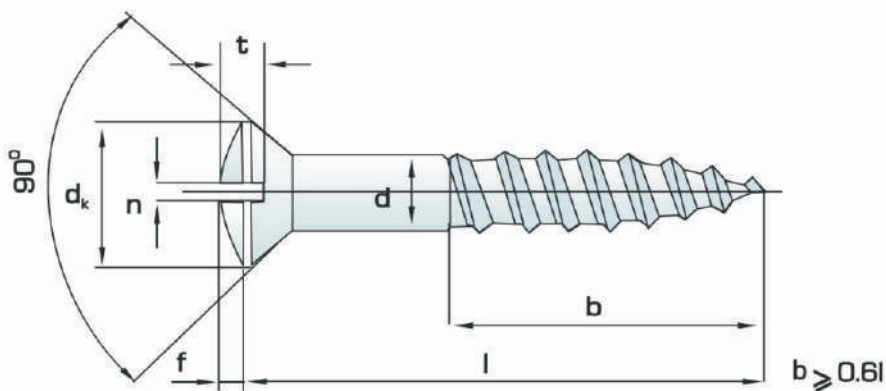

Thread size (d)		3	3.5	4	4.5	5	(5.5)	6	(8)
d _k	max.	5.98	6.95	7.95	8.75	9.65	10.75	11.55	15.05
	min.	5.23	6.05	7.05	7.85	8.75	9.65	10.45	13.95
f		0.75	0.9	1.0	1.1	1.25	1.4	1.5	2.0
k	max.	1.65	1.93	2.2	2.35	2.5	2.75	3.0	4.0
n	max.	1.0	1.0	1.2	1.2	1.51	1.51	1.91	2.31
	min.	0.8	0.8	1.0	1.0	1.2	1.2	1.6	2.0
t	max.	1.45	1.7	1.9	2.1	2.3	2.5	2.8	3.7
	min.	1.2	1.4	1.6	1.8	2.0	2.2	2.4	3.2

* All Dimensions in mm

DIN 96 / IS : 6739 - 1972

Slotted Round Head Wood Screws

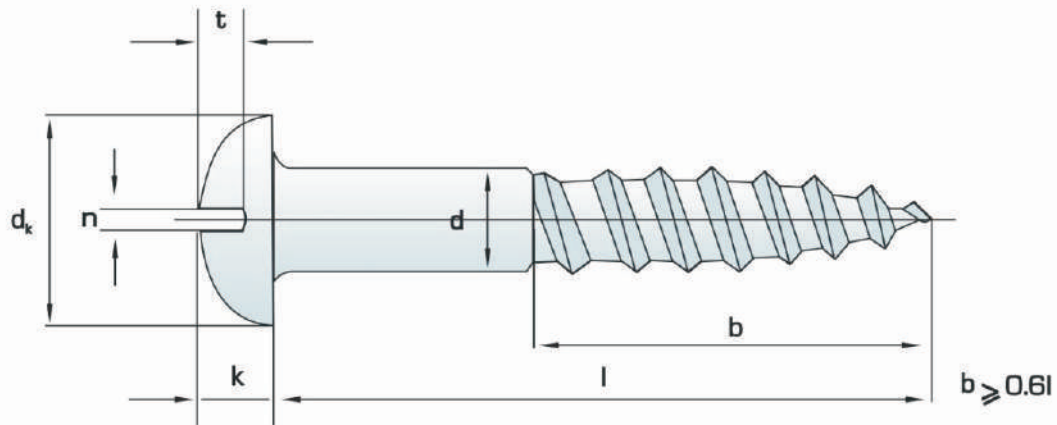

Thread size (d)		3	3.5	4	4.5	5	(5.5)	6	(8)
d_k	max.	6.38	7.45	8.45	9.45	10.45	11.55	12.55	16.55
	min.	5.62	6.55	7.55	8.55	9.55	10.45	11.45	15.45
k	max.	2.3	2.6	3.0	3.34	3.74	4.04	4.44	5.84
	min.	1.9	2.1	2.6	2.86	3.26	3.56	3.96	5.36
n	max.	1.0	1.0	1.2	1.2	1.51	1.51	1.91	2.31
	min.	0.8	0.8	1.0	1.0	1.2	1.2	1.6	2.0
t	max.	1.35	1.6	1.8	2.0	2.3	2.5	2.7	3.6
	min.	1.05	1.2	1.4	1.55	1.75	1.9	2.1	2.8

* All Dimensions in mm

DIN 97 / IS : 6760 - 1972

Slotted Countersunk Head Wood Screws

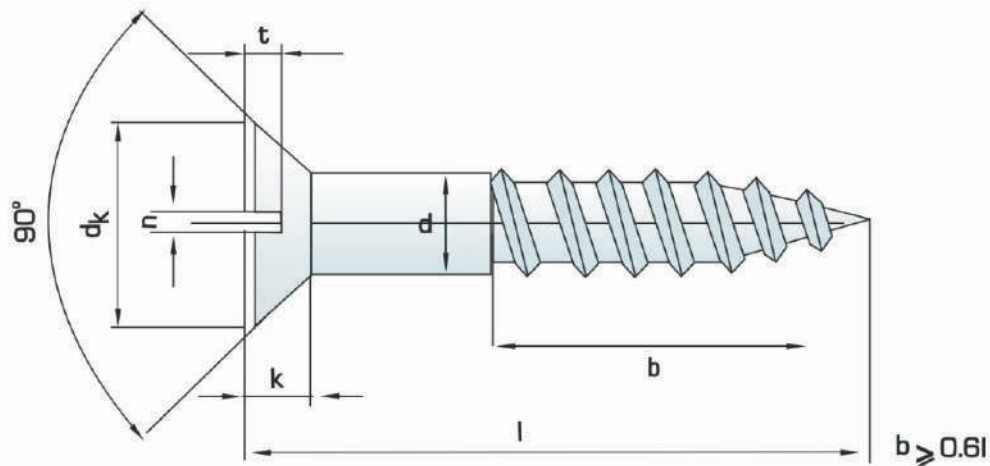

Thread size [d]	M 2	(M 2.5)	M 3	M 3.5	M 4	M 4.5	M 5	(M 5.5)	M 6	(M 7)	M 8	M 10	
d_k	max.	4.18	5.08	5.98	6.95	7.95	8.75	9.65	10.75	11.55	13.05	15.05	18.55
	min.	3.43	4.33	5.23	6.05	7.05	7.85	8.75	9.65	10.45	11.95	13.95	17.45
k	max.	1.2	1.5	1.65	1.93	2.2	2.35	2.5	2.75	3	3.5	4	5
n	max.	0.7	0.8	1	1	1.2	1.2	1.51	1.51	1.91	2.31	2.31	2.81
	min.	0.56	0.66	0.86	0.86	1.06	1.06	1.26	1.26	1.66	2.06	2.06	2.56
t	max.	0.6	0.7	0.85	1	1.1	1.2	1.3	1.4	1.6	1.9	2.1	2.6
	min.	0.4	0.5	0.6	0.7	0.8	0.9	1	1.1	1.2	1.4	1.6	2

* All Dimensions in mm

DIN 125 / IS : 2016 - 1967 / ISO 7089

Plain Washers

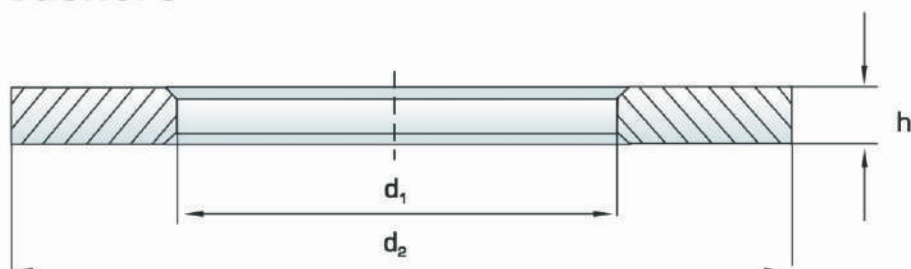

Normal size	For thread size M	d_1		d_2		h	
		min.	max.	min.	max.	max.	min.
1.7	1.6	1.7	1.84	4.0	3.7	0.35	0.25
1.8	1.7	1.8	1.94	4.5	4.2	0.35	0.25
2.2	2.0	2.2	2.34	5.0	4.7	0.35	0.25
2.5	2.3	2.5	2.64	6.0	5.7	0.55	0.45
2.7	2.5	2.7	2.84	6.0	5.7	0.55	0.45
2.8	2.6	2.8	2.94	7.0	6.64	0.55	0.45
3.2	3.0	3.2	3.38	7.0	6.64	0.55	0.45
3.7	3.5	3.7	3.88	8.0	7.64	0.55	0.45
4.3	4.0	4.3	4.48	9.0	8.64	0.9	0.7
5.3	5.0	5.3	5.48	10.0	9.64	1.1	0.9
6.4	6.0	6.4	6.62	12.0	11.57	1.8	1.4
7.4	7.0	7.4	7.62	14.0	13.57	1.8	1.4
8.4	8.0	8.4	8.62	16.0	15.57	1.8	1.4
10.5	10.0	10.5	10.77	20.0	19.48	2.2	1.8
13.0	12.0	13.0	13.27	24.0	23.48	2.7	2.3
15.0	14.0	15.0	15.27	28.0	27.48	2.7	2.3
17.0	16.0	17.0	17.27	30.0	29.48	3.3	2.7
19.0	18.0	19.0	19.33	34.0	33.38	3.3	2.7
21.0	20.0	21.0	21.33	37.0	36.38	3.3	2.7
23.0	22.0	23.0	23.33	39.0	38.38	3.3	2.7
25.0	24.0	25.0	25.33	44.0	43.38	4.3	3.7

* All Dimensions in mm

DIN 660 / ISO R - 1051

Round Head Rivets

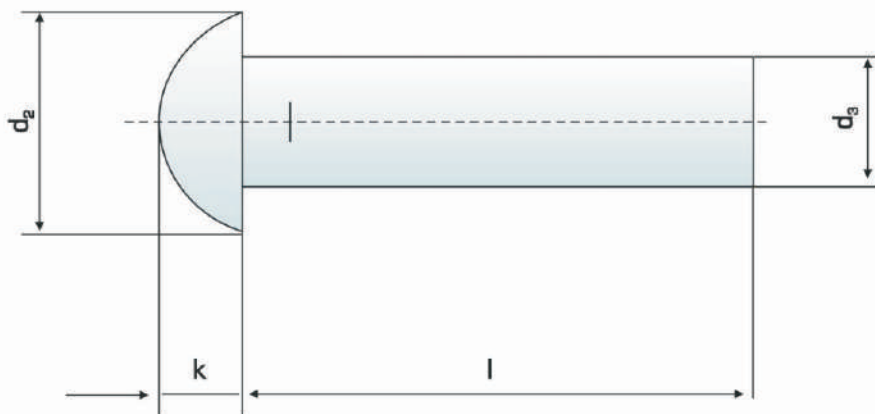

Nominal Size (d)	1.6	2	2.5	3	4	5	6	8
d_2	2.8	3.5	4.4	5.2	7	8.8	10.5	14
d_3	1.52	1.87	2.37	2.87	3.87	4.82	5.82	7.76
k	1.0	1.2	1.5	1.8	2.4	3.0	3.6	4.8

* All Dimensions in mm

DIN 661 / ISO R - 1051

Countersunk Head Rivets

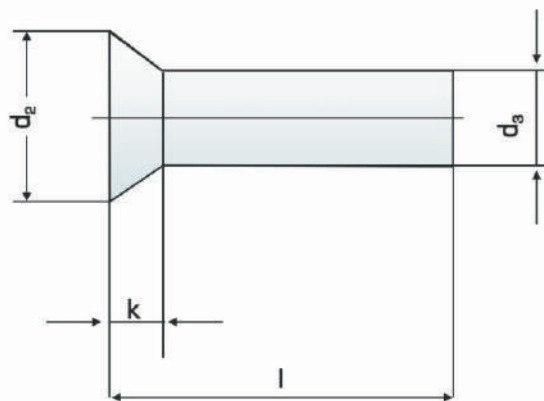

Nominal Size [d]	1.6	2	2.5	3	4	5	6	8
d_2 min	2.8	3.5	4.4	5.2	7	8.8	10.5	14
d_3	1.52	1.87	2.37	2.87	3.87	4.82	5.82	7.76
k	0.8	1	1.2	1.4	2.00	2.5	3	4

* All Dimensions in mm

DIN 912 / ISO 4762

Hexagon Socket Head Cap Screws

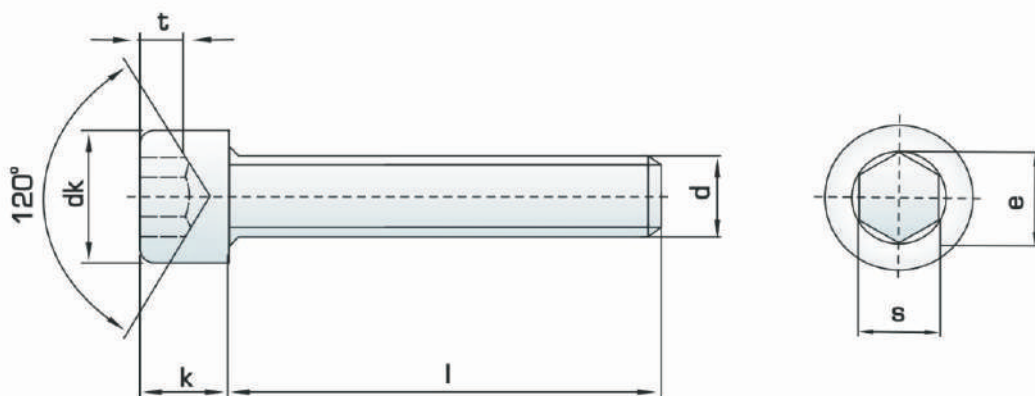

Thread size d	M3	M4	M5	M6	M8	M10	M12	M14	M16	M18	M20	
Pitch	0.5	0.7	0.8	1	1.25	1.5	1.75	2	2	2.5	2.5	
d _k	min.	5.32	6.78	8.28	9.78	12.73	15.73	17.73	20.67	23.67	26.67	29.67
	max.	5.68	7.22	8.72	10.22	13.27	16.27	18.27	21.33	24.33	27.33	30.33
e	min.	2.87	3.44	4.58	5.72	6.86	9.15	11.43	13.72	16	16	19.44
	max.	3	4	5	6	8	10	12	14	16	18	20
k	min.	2.86	3.82	4.82	5.7	7.64	9.64	11.57	13.57	15.57	17.57	19.48
	max.	2.52	3.02	4.02	5.02	6.02	8.02	10.02	12.03	14.03	14.03	17.05
s	min.	2.52	3.02	4.02	5.02	6.02	8.02	10.02	12.03	14.03	14.03	17.05
	max.	2.58	3.08	4.09	5.14	6.14	8.175	10.17	12.21	14.21	14.21	17.23
t	min	1.3	2	2.5	3	4	5	6	7	8	9	10

* All Dimensions in mm

DIN 913 / IS : 6094 -1981 (Type FP) / ISO 4026

Hexagon Socket Set Screws with Flat Point

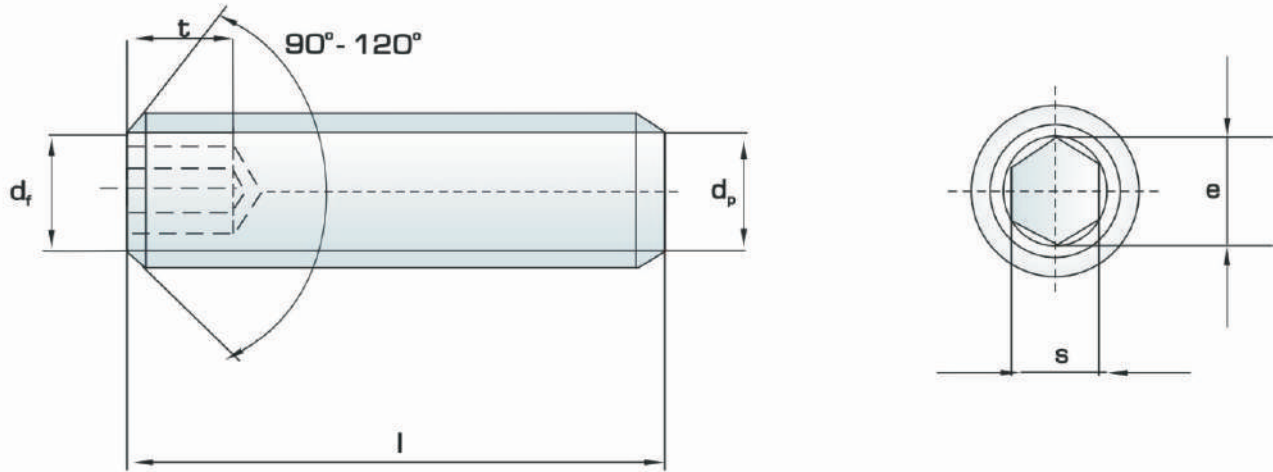

Thread size (d)	M3	M4	M5	M6	M8	M10	M12
Pitch	0.5	0.7	0.8	1.0	1.25	1.5	1.75
e min.	1.73	2.30	2.87	3.44	4.58	5.72	6.86
s min.	1.5	2.00	2.5	3.0	4.0	5.0	6.0
s max.	1.54	2.04	2.56	3.08	4.09	5.09	6.09
t min.	1.2	1.5	2.0	2.0	3.0	4.0	4.8

* All Dimensions in mm

DIN 933

Hexagon Head Screws

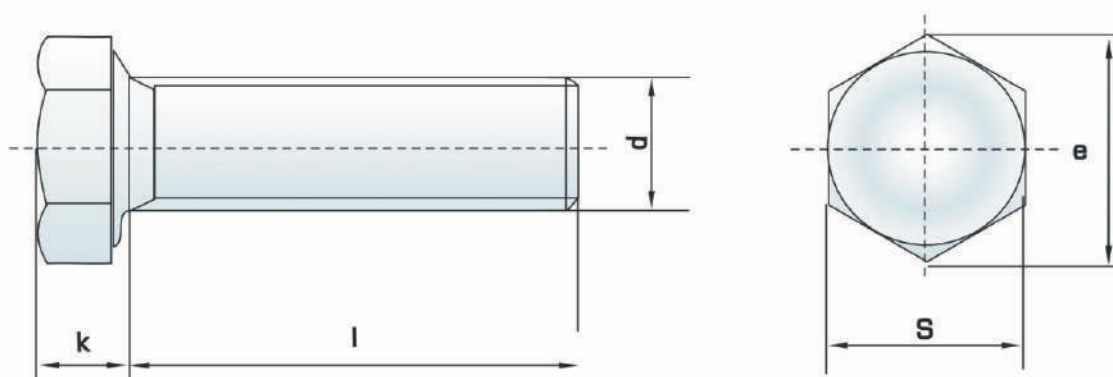

Thread size	M3	M3.5	M4	M5	M6	M8	M10	M12	M14	M16	M18	M20	M24
Pitch	0.5	0.6	0.7	0.8	1	1.25	1.5	1.75	2	2	2.5	2.5	3
e min.	6.01	6.58	7.66	8.79	11.05	14.38	18.9	21.1	24.49	26.75	30.14	33.53	39.98
min k	1.88	2.28	2.68	3.35	3.85	5.15	6.22	7.32	8.62	9.82	11.28	12.28	14.78
max k	2.12	2.52	2.92	3.65	4.15	5.45	6.56	7.68	8.98	10.18	11.72	12.72	15.22
max s	5.5	6	7	8	10	13	17	19	22	24	27	30	36
min s	5.32	5.82	6.78	7.78	9.78	12.73	16.73	18.67	21.67	23.67	26.67	29.67	35.38

* All Dimensions in mm

IS : 1364 (P2) - 1992 / ISO - 4017

Hexagon Head Screws

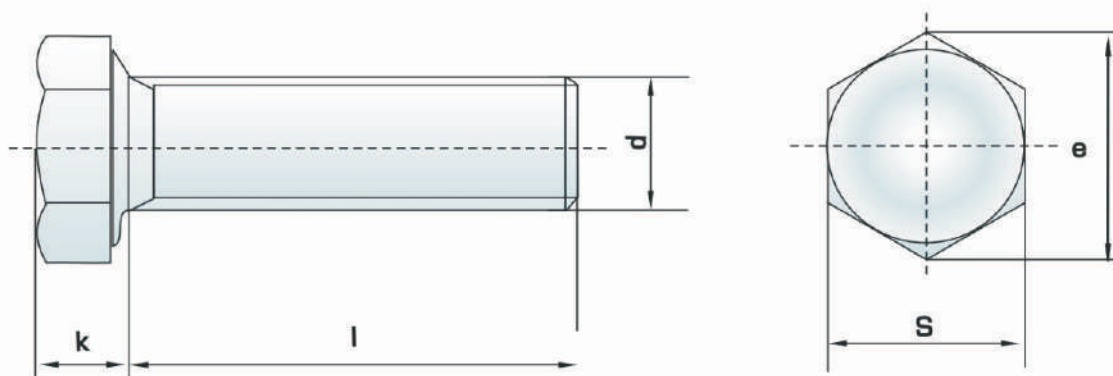

Thread size	M3	M3.5	M4	M5	M6	M8	M10	M12	M14	M16	M18	M20	M24
Pitch	0.5	0.6	0.7	0.8	1	1.25	1.5	1.75	2	2	2.5	2.5	3
e min.	6.01	6.58	7.66	8.79	11.05	14.38	17.77	20.03	23.36	26.75	30.14	33.53	39.98
min k	1.88	2.28	2.68	3.35	3.85	5.15	6.22	7.32	8.62	9.82	11.28	12.28	14.78
max k	2.12	2.52	2.92	3.65	4.15	5.45	6.58	7.68	8.98	10.18	11.72	12.72	15.22
max s	5.5	6	7	8	10	13	16	18	21	24	27	30	36
min s	5.32	5.82	6.78	7.78	9.78	12.73	15.73	17.73	20.67	23.67	26.67	29.67	35.38

* All Dimensions in mm

DIN 934

Hexagon Nuts

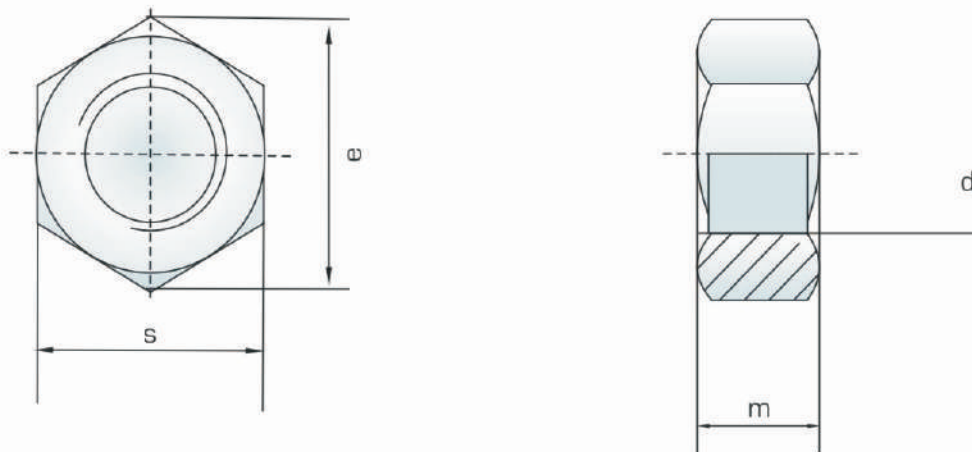

Thread size [d]	M1.6	M2	M2.5	M3	(M3.5)	M4	M5	M6
Pitch	0.35	0.4	0.45	0.5	0.6	0.7	0.8	1
e min.	3.41	4.32	5.45	6.01	6.58	7.66	8.79	11.05
m	max	1.3	1.6	2	2.4	2.8	4	5
	min	1.05	1.35	1.75	2.15	2.55	2.9	4.7
s	max	3.2	4	5	5.5	6	8	10
	min	3.02	3.82	4.82	5.32	5.82	6.78	9.78

Thread size [d]	M8	M10	M12	M14	M16	M18	M20	M24
Pitch	1.25	1.5	1.75	2	2	2.5	2.5	3
e min.	14.38	18.9	21.1	24.49	26.75	29.56	32.95	39.55
m	max	6.5	8	10	11	13	16	19
	min	6.14	7.64	9.64	10.3	12.3	14.9	17.7
s	max	13	17	19	22	24	30	36
	min	12.73	16.73	18.67	21.67	23.67	29.16	35

* All Dimensions in mm

IS : 1364 P3 - 2002 / ISO - 4032

Hexagon Nuts

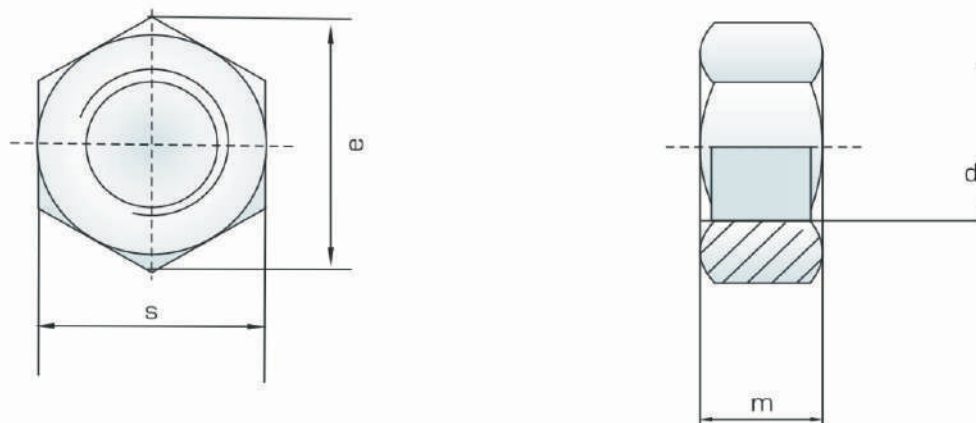

Thread size (d)	M1.6	M2	M2.5	M3	(M3.5)	M4	M5	M6
Pitch	0.35	0.4	0.45	0.5	0.6	0.7	0.8	1
e min.	3.41	4.32	5.45	6.01	6.58	7.66	8.79	11.05
m	max	1.3	1.6	2	2.4	2.8	4.7	5.2
	min	1.05	1.35	1.75	2.15	2.55	4.4	4.9
s	max	3.2	4	5	5.5	6	8	10
	min	3.02	3.82	4.82	5.32	5.82	6.78	9.78

Thread size (d)	M8	M10	M12	M14	M16	M18	M20	M24
Pitch	1.25	1.5	1.75	2	2	2.5	2.5	3
e min.	14.38	17.77	20.03	23.36	26.75	29.56	32.95	39.55
m	max	6.5	8.4	10.8	12.8	14.8	18	19
	min	6.14	8.04	10.37	12.1	14.1	16.9	17.7
s	max	13	16	18	21	24	30	36
	min	12.73	15.73	17.73	20.67	23.67	29.16	35

* All Dimensions in mm

DIN 964 / IS : 8911 -1988 / ISO 2010

Slotted Raised Countersunk Head Screws

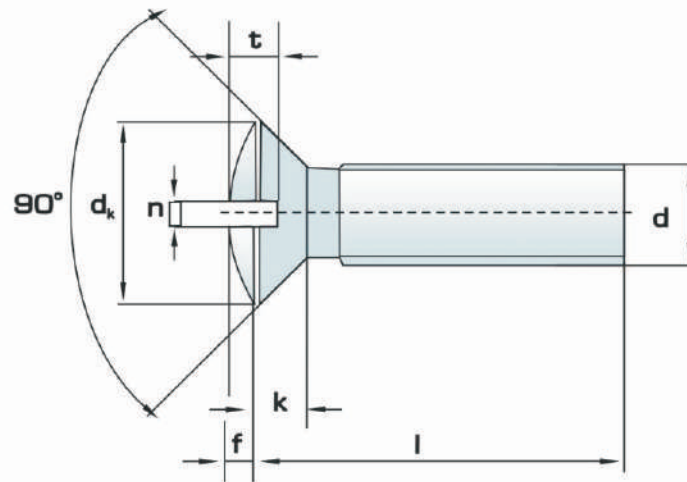

Thread size (d)	M2	M2.5	M3	(M3.5)	M4	M5	M6	M8	M10	M12	
Pitch	0.4	0.45	0.5	0.6	0.7	0.8	1.0	1.25	1.5	1.75	
d_k	max	3.8	4.7	5.6	6.5	7.5	9.2	11.0	14.5	18.0	22.0
	min	3.5	4.4	5.3	6.14	7.14	8.84	10.57	14.07	17.5	21.48
f	0.5	0.6	0.75	0.9	1.0	1.25	1.5	2.0	2.5	3.00	
k max	1.2	1.5	1.65	1.93	2.2	2.5	3.0	4.0	5.0	6.00	
n	min	0.56	0.66	0.86	0.86	1.06	1.26	1.66	2.06	2.56	3.06
	max	0.7	0.8	1.0	1.0	1.2	1.51	1.91	2.31	2.81	3.31
t	min	0.8	1.0	1.2	1.4	1.6	2.0	2.4	3.2	4.0	4.8
	max	1.0	1.2	1.45	1.7	1.9	2.3	2.8	3.7	4.5	5.4

* All Dimensions in mm

DIN 965 / IS : 7485 - 1985 / ISO 7046

Cross recessed Countersunk Flat Head Screws

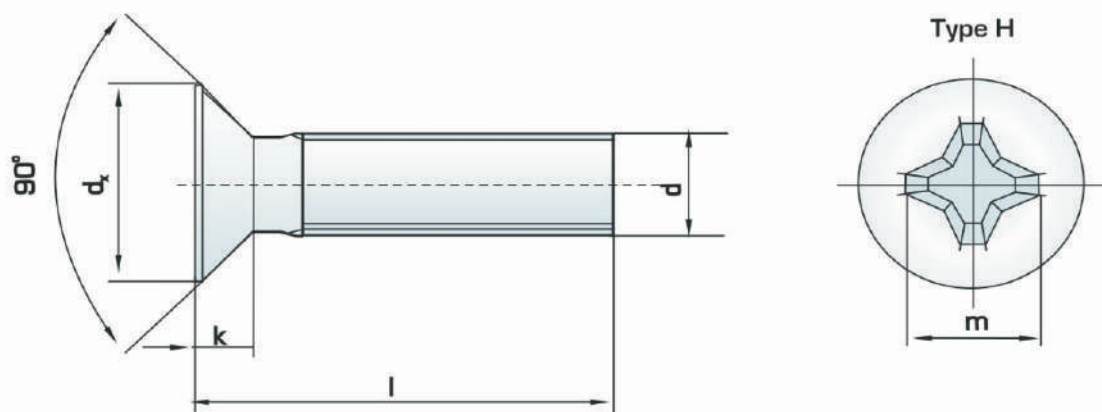

Thread size (d)	M2	M2.5	M3	(M3.5)	M4	M5	M6	M8	M10	
Pitch	0.4	0.45	0.5	0.6	0.7	0.8	1	1.25	1.5	
d_k	max	3.8	4.7	5.6	6.5	7.5	9.2	11	14.5	18
	min	3.5	4.4	5.3	6.14	7.14	8.84	10.57	14.07	17.57
k	max	1.2	1.5	1.65	1.93	2.2	2.5	3	4	5
Cross recess no.	1			2			3	4		
m	2.35	2.7	2.9	3.9	4.4	4.6	6.6	8.7	9.6	
penetration min	0.95	1.25	1.5	1.4	1.9	2.1	2.8	3.9	4.8	
type H										
Depth	max	1.25	1.55	1.8	1.9	2.4	2.6	3.3	4.4	5.3

* All Dimensions in mm

DIN 7973/IS : 7169-1974/ISO 1483

Slotted Raised Countersunk Head Tapping Screws

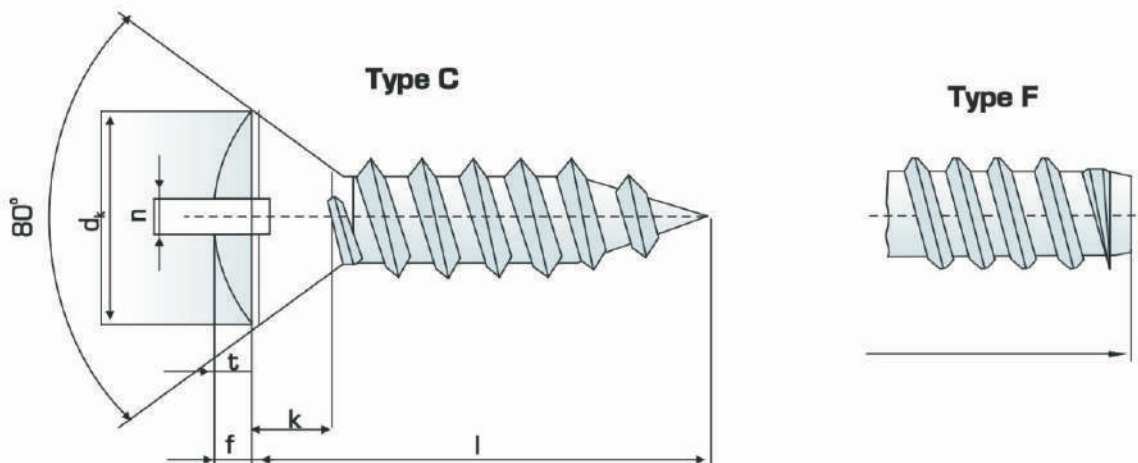

Thread size (d)	ST 2.2	ST 2.9	ST 3.5	ST 4.2	ST 4.8	ST 5.5	ST 6.3	
No	#4	#5	#6	#8	#10	#12	#14	
Pitch	0.8	1.1	1.3	1.4	1.6	1.8	1.8	
d_k	max	4.3	5.5	6.8	8.1	9.5	10.8	12.4
	min	4	5.2	6.44	7.74	9.14	10.37	11.97
k	1.3	1.7	2.1	2.5	3.0	3.4	3.8	
f	0.7	0.9	1.2	1.4	1.5	1.7	2.0	
n	min	0.6	0.8	1.0	1.2	1.2	1.6	1.6
	max	0.8	1	1.2	1.51	1.51	1.91	1.91
t	min	0.95	1.25	1.55	1.85	2.15	2.45	2.85
	max	1.15	1.5	1.9	2.25	2.6	2.95	3.45

* All Dimensions in mm

DIN 7976

Hexagon Head Tapping Screws, ISO - 1479

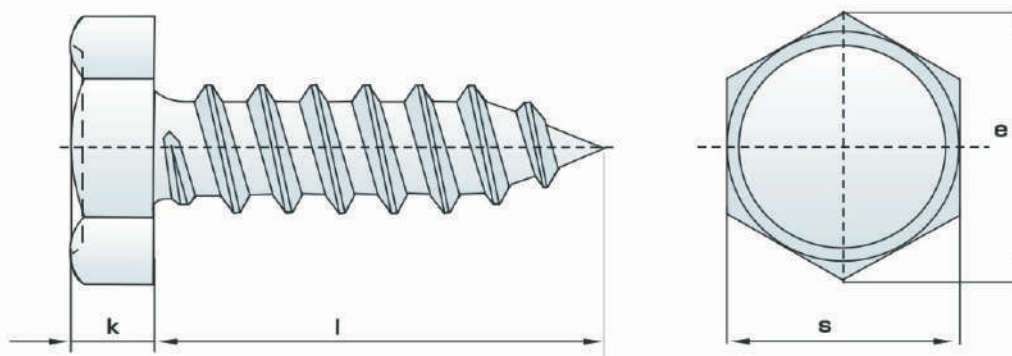

Thread size (d)	ST 2.9	ST 3.5	ST 4.2	ST 4.8	ST 5.5	ST 6.3
No	#5	#6	#8	#10	#12	#14
Pitch	1.1	1.3	1.4	1.6	1.8	1.8
e min	5.4	5.96	7.59	8.71	8.71	10.95
k	min	1.38	2.18	2.68	3.85	4.65
	max	1.62	2.42	2.92	3.12	4.95
s	max	5.0	5.5	7.0	8.0	10
	min	4.82	5.32	6.78	7.78	9.78

* All Dimensions in mm



Kishor
Industries

📍 Plot No.3643, G.I.D.C., Phase-III, Dared, Jamnagar - 361 004 (Gujarat) INDIA

📞 +91 90048 25447 📞 +91 92274 83994 📞 +91 94272 80346

✉️ kifastnersindia@gmail.com • kishorindindia@gmail.com • bhavya.doshi92@gmail.com